

# Map and Floor Plan

## Campus Map

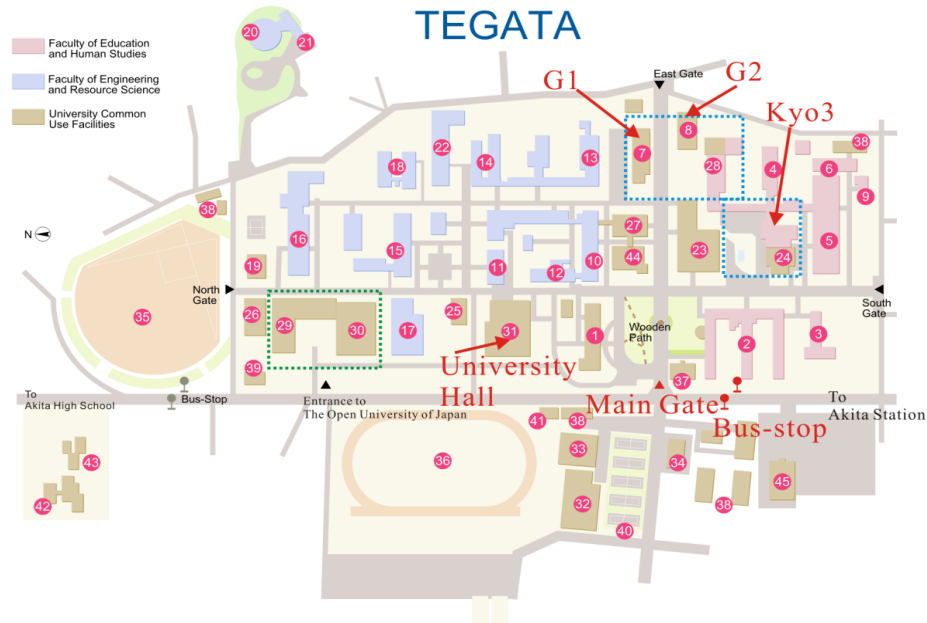

### Map of Tegata Campus

- |  |   |
|--|---|
| <ol style="list-style-type: none"> <li>1 Administrative Office Bldg., Admission Division, Office of Teaching License Extension, Public Contribution Division, Center for Evaluation, Support Office for Gender Equality</li> <li>2 Faculty of Education and Human Studies Bldg. No.1 (Administration Bldg.)</li> <li>3 Faculty of Education and Human Studies Bldg. No.2 (Music Bldg.)</li> <li>4 Faculty of Education and Human Studies Bldg. No.3</li> <li>5 Faculty of Education and Human Studies Bldg. No.4</li> <li>6 Faculty of Education and Human Studies Bldg. No.5</li> <li>7 General Education Bldg. No.1, International Exchange Center (International Exchange Division, Multicultural Lounge)</li> <li>8 General Education Bldg. No.2</li> <li>9 Center for Educational Research and Practice</li> <li>10 Faculty of Engineering and Resource Science Bldg. No.1 (Administration Bldg.)</li> <li>11 Faculty of Engineering and Resource Science Bldg. No.1 (Dept. of Electrical and Electronics Engineering / Dept. of Civil and Environmental Engineering)</li> <li>12 Faculty of Engineering and Resource Science Bldg. No.1 (Dept. of Electrical and Electronics Engineering)</li> <li>13 Faculty of Engineering and Resource Science Bldg. No.2 (Dept. of Earth Science and Technology)</li> <li>14 Faculty of Engineering and Resource Science Bldg. No.2 (Dept. of Mechanical Engineering)</li> <li>15 Faculty of Engineering and Resource Science Bldg. No.3 (Dept. of Materials Science and Engineering)</li> </ol> | <ol style="list-style-type: none"> <li>16 Faculty of Engineering and Resource Science Bldg. No.4 (Dept. of Engineering in Applied Chemistry / Dept. of Life Science)</li> <li>17 Faculty of Engineering and Resource Science Bldg. No.5 (Dept. of Computer Science and Engineering)</li> <li>18 Center for Geo-Environmental Science</li> <li>19 Radioisotope Research Center</li> <li>20 Mineral Industry Museum</li> <li>21 Research Center for Potential Development of Disaster Prevention</li> <li>22 Innovation Center for Engineering Design and Manufacturing</li> <li>23 University Library</li> <li>24 The 60<sup>th</sup> Anniversary Memorial Hall</li> <li>25 University Health Center</li> <li>26 Cooperative Research Center</li> <li>27 General Information Processing Center</li> <li>28 International Center for Research and Education on Mineral and Energy</li> <li>29 Venture Business Laboratory, The Open University of Japan</li> <li>30 Akita Study Center</li> <li>31 General Research Bldg.</li> <li>32 University Hall (Clair)</li> <li>33 Large Gymnasium</li> <li>34 Small Gymnasium</li> <li>35 Swimming Pool</li> <li>36 Baseball Field</li> <li>37 Athletic Field</li> <li>38 Information Center</li> <li>39 Facility for Extra Curricular Activities</li> <li>40 Japanese-style Archery Hall</li> <li>41 Tennis Court</li> <li>42 Clubhouse</li> <li>43 International House</li> <li>44 Residence Hall for Women (Tegata-Ryo)</li> <li>45 Student Support Bldg., Center for Promotion of Education Research and Affairs, Student Support Center</li> <li>46 Venture Incubation Center</li> </ol> |
|--|---|

- G1**  
**1F**  
 - Registration  
 - Cloak  
 - Exhibition  
**2F**  
 - Headquarters  
**3F**  
 - Tutorial I  
 - Track 01  
**4F**  
 - Tutorial II  
 - Track 02

- G2**  
**1F**  
 - Track 03-05  
**2F**  
 - Track 06  
**3F**  
 - Track 07-08

- Kyo3**  
**1F**  
 - Plenary Talk  
 - Workshop A  
**2F**  
 - Track 09-10  
**3F**  
 - Track 11-12

- University Hall**  
 - Poster Session  
 - Opening Ceremony and Welcome Reception  
 - Closing Ceremony and Farewell Reception

# General Education Bldg. No.1 (G1)

1F

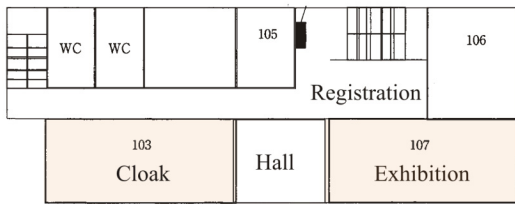

2F

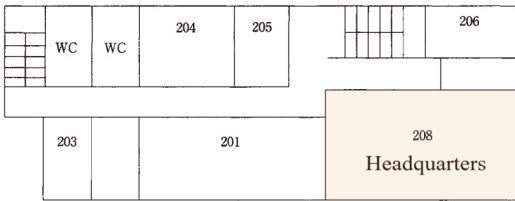

3F

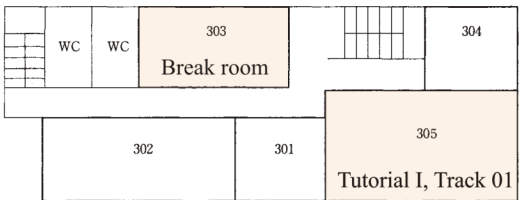

4F

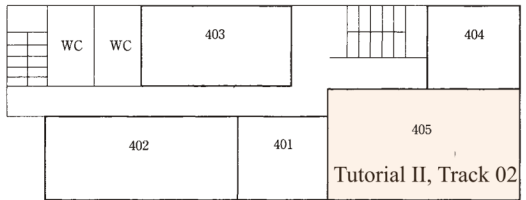

G1-305			
Aug. 20	Aug. 21	Aug. 22	Aug. 23
	TuA01	WeA01	ThA01
Tutorial I	TuB01	WeB01	ThB01
	TuC01	-	ThC01
G1-405			
Aug. 20	Aug. 21	Aug. 22	Aug. 23
	TuA02	WeA02	ThA02
Tutorial II	TuB02	WeB02	ThB02
	TuC02	-	ThC02

## General Education Bldg. No.2 (G2)

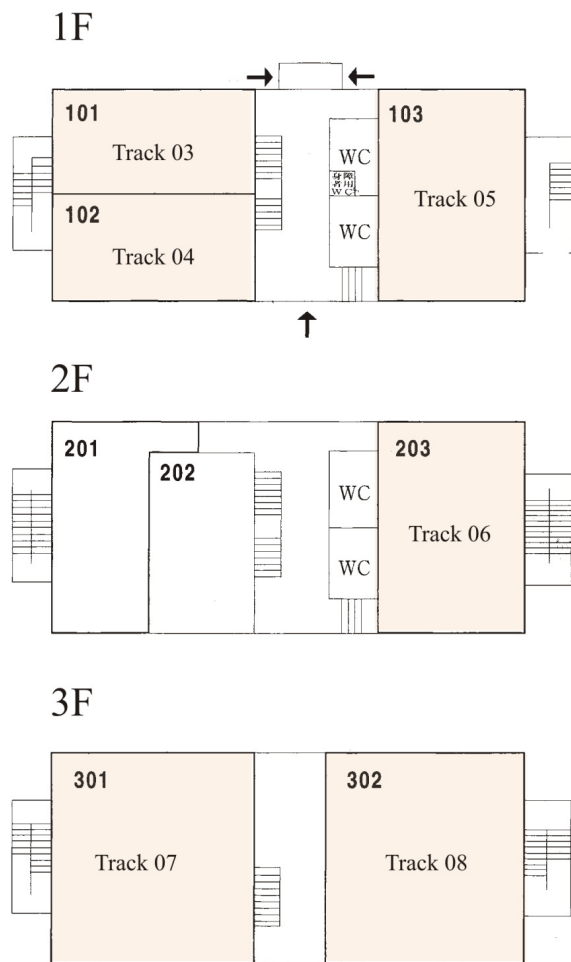

<b>G2-101</b>		
<b>Aug. 21</b>	<b>Aug. 22</b>	<b>Aug. 23</b>
TuA03	WeA03	ThA03
TuB03	WeB03	ThB03
TuC03	-	ThC03
<b>G2-102</b>		
<b>Aug. 21</b>	<b>Aug. 22</b>	<b>Aug. 23</b>
TuA04	WeA04	ThA04
TuB04	WeB04	ThB04
TuC04	-	ThC04
<b>G2-103</b>		
<b>Aug. 21</b>	<b>Aug. 22</b>	<b>Aug. 23</b>
TuA05	WeA05	ThA05
TuB05	WeB05	ThB05
TuC05	-	ThC05
<b>G2-203</b>		
<b>Aug. 21</b>	<b>Aug. 22</b>	<b>Aug. 23</b>
TuA06	WeA06	-
TuB06	WeB06	-
TuC06	-	-
<b>G2-301</b>		
<b>Aug. 21</b>	<b>Aug. 22</b>	<b>Aug. 23</b>
TuA07	WeA07	-
TuB07	WeB07	-
TuC07	-	-
<b>G2-302</b>		
<b>Aug. 21</b>	<b>Aug. 22</b>	<b>Aug. 23</b>
TuA08	WeA08	-
TuB08	WeB08	-
TuC08	-	-

Faculty of Education and Human Studies Bldg. No.3 (Kyo3)

1F

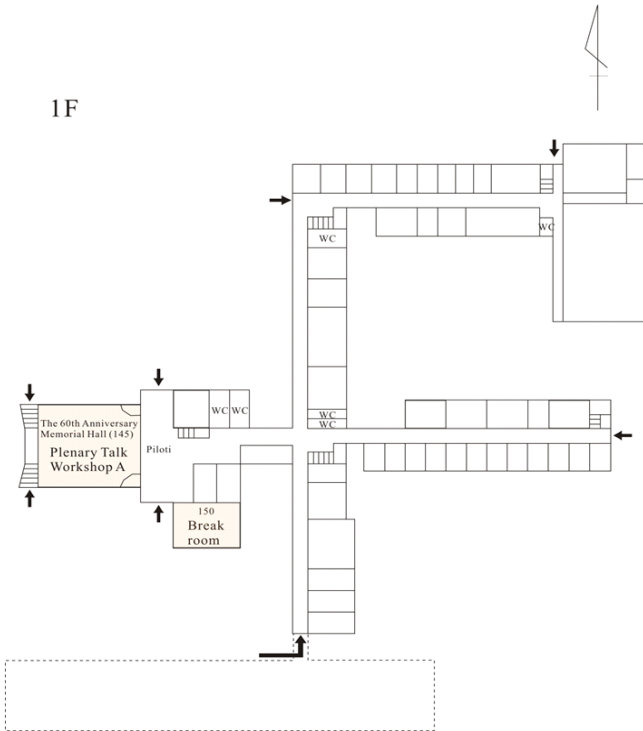

Kyo3-145			
Aug. 20	Aug. 21	Aug. 22	Aug. 23
-	Plenary I	Plenary II	Plenary IV
WS A	-	-	-
	-	Plenary III	-

Faculty of Education and Human Studies Bldg. No.3 (Kyo3)

2F

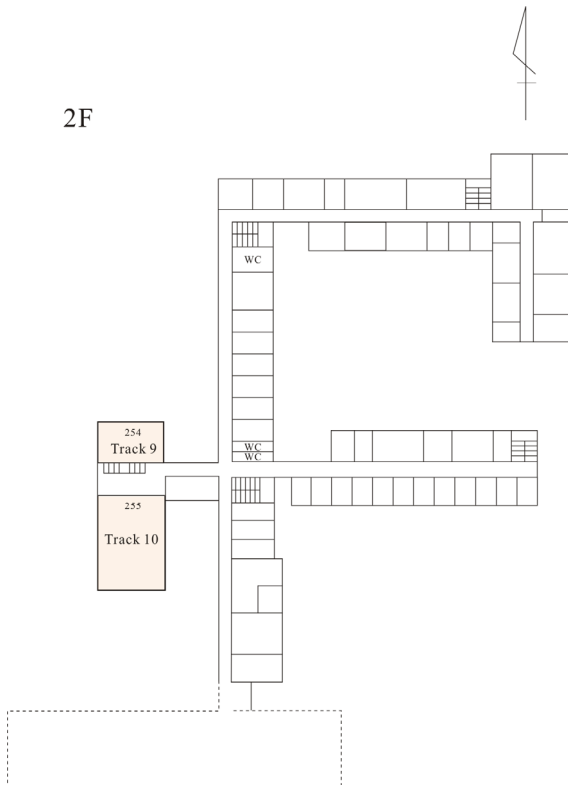

Kyo3-254		
Aug. 21	Aug. 22	Aug. 23
TuA09	WeA09	-
TuB09	WeB09	-
-	-	-
Kyo3-255		
Aug. 21	Aug. 22	Aug. 23
TuA10	WeA10	-
TuB10	WeB10	-
TuC10		-

Faculty of Education and Human  
Studies Bldg. No.3 (Kyo3)

3F

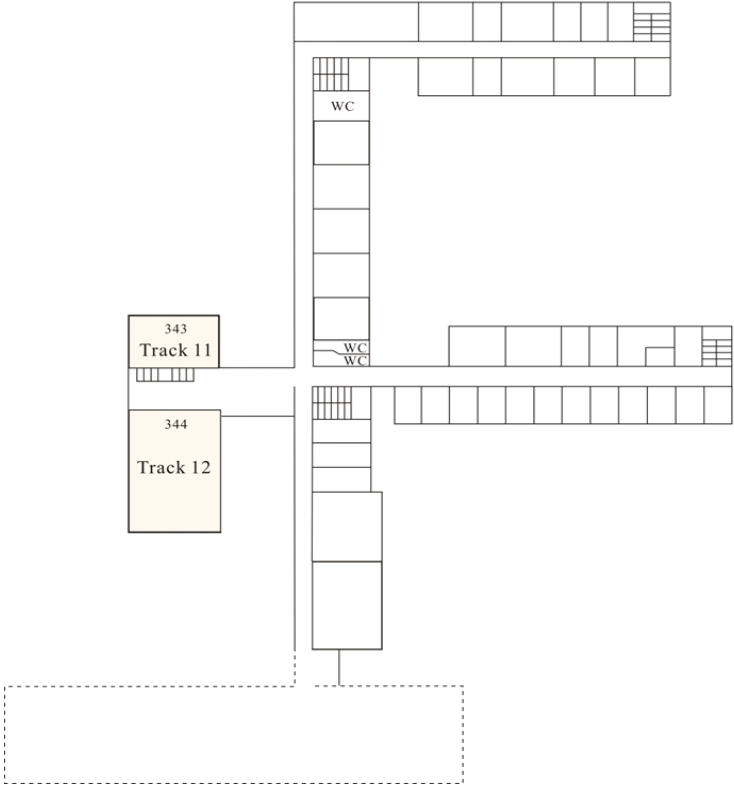

Kyo3-343		
Aug. 21	Aug. 22	Aug. 23
TuA11	WeA11	-
TuB11	WeB11	-
-	-	-
Kyo3-344		
Aug. 21	Aug. 22	Aug. 23
TuA12	WeA12	-
TuB12	WeB12	-
TuC12		-

# University Hall

1F

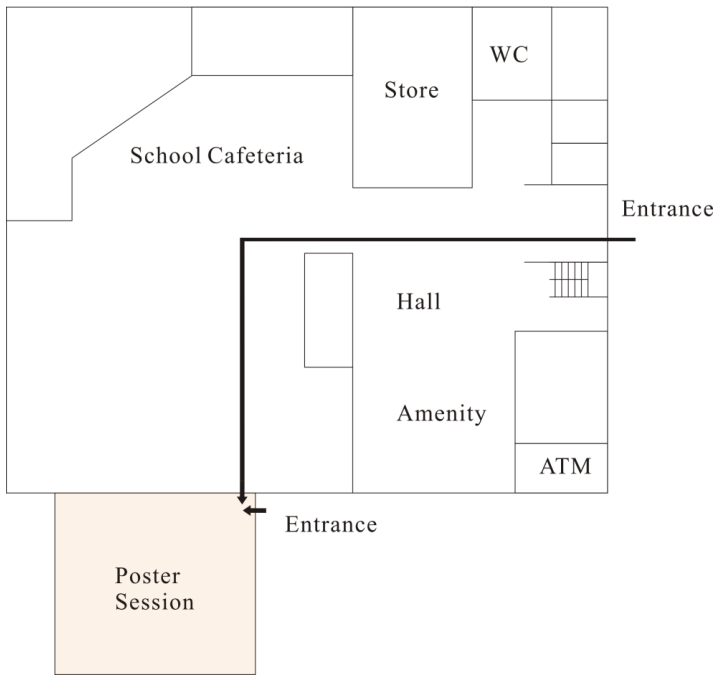

University Hall		
Aug. 21	Aug. 22	Aug. 23
-	-	-
TuP01	WeP02	-
-	-	-
University Hall		
Aug. 21	Aug. 22	Aug. 23
-	-	-
TuP01	WeP02	-
-	-	-